



INSTRUCTION BULLETIN

No. 9007999
Machine: See Below
Published: 08-2015
Rev. 01

NOTE: DO NOT DISCARD the Parts List from the Instruction Bulletin. Place the Parts List in the appropriate place in the machine manual for future reference. Retaining the Parts List will make it easier to reorder individual parts and will save the cost of ordering an entire kit.

NOTE: Numbers in parenthesis () are reference numbers for parts listed in Bill of Materials.

Installation instructions for **kit number 9006895**

SYNOPSIS:

This kit contains the parts needed to replace the engine flywheel starter plate on the following machines: **6600, 6650, 8200, 8210, 7400, M20** serial numbers 000000- 003122, **M30** serial numbers 000000- 001320, **T20** serial numbers 000000- 002140, **S30** serial numbers 000000- 001970. Please follow step-by-step instructions.

SPECIAL TOOLS / CONSIDERATIONS: NONE

(Estimated time to complete: 8- 10 hours)

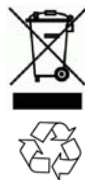

PROTECT THE ENVIRONMENT

Please dispose of packaging materials, used machine components such as batteries and fluids in an environmentally safe way according to local waste disposal regulations.

Always remember to recycle.

PREPARATION:

1. Park the machine on a clean level surface, turn off the machine, remove the key, and set the parking brake.

FOR SAFETY: Before leaving or servicing machine, stop on level surface, turn off machine, and remove key.

2. Open the engine compartment and remove the old starter ring.

INSTALLATION:

When replacing the flywheel starter ring, be sure to install the spacer to maintain the correct distance between the flywheel and the engine. (Fig. 1)

NOTE: Refer to GM Engine Service Manual for additional information.

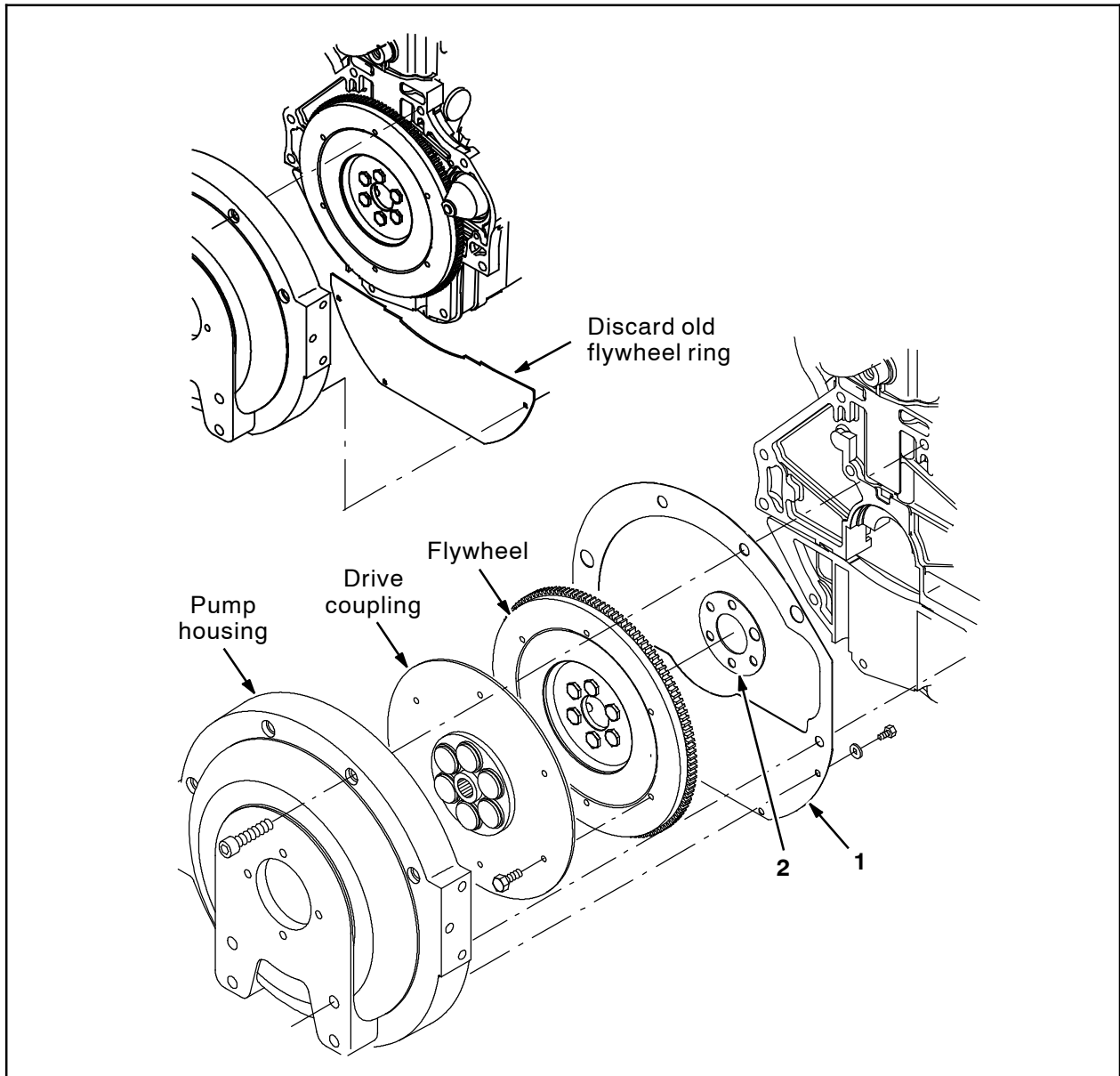

FIG. 1

Bill of Materials for Plate Kit, Repair - 9006895

Ref.	Part No.	Description	Qty.
▽	9006895	Plate Kit, Repair	1
▲	1 1057036	Plate, Ring, Starter [GM1.6L]	1
▲	2 1057052	Spacer, 41.0MMB X 85.0MMD X 18GA	1

TENNANT COMPANY
P. O. Box 1452
Minneapolis, MN 55440-1452